

Ansamblu GS2 - 21 buc.

scara 1:20

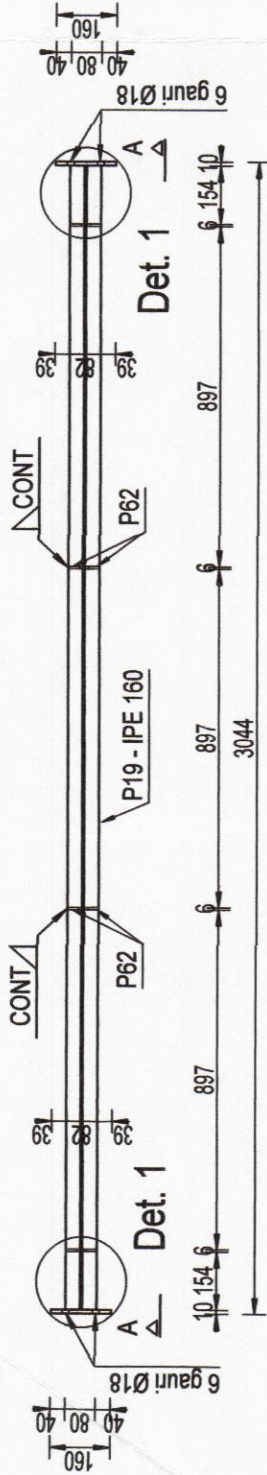

Vedere A - A

scara 1:20

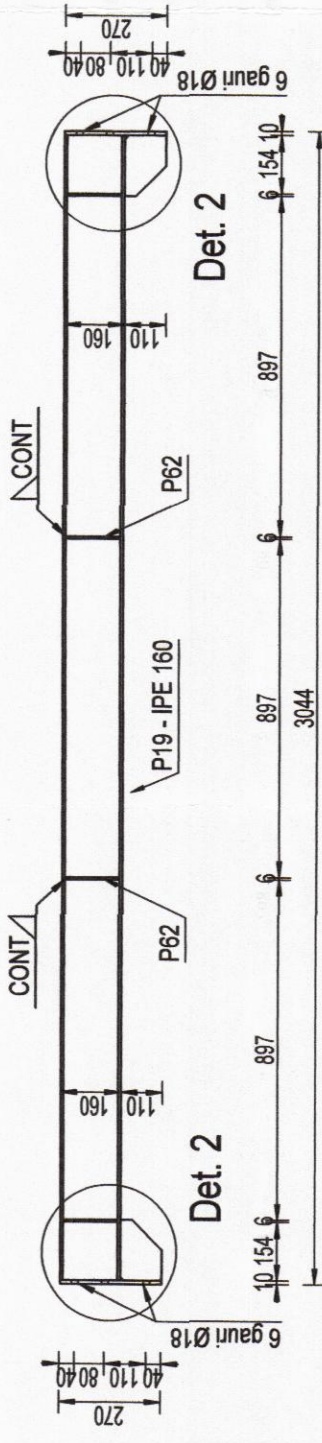

P19 - IPE160

L=3024 - 1 buc.

scara 1:20

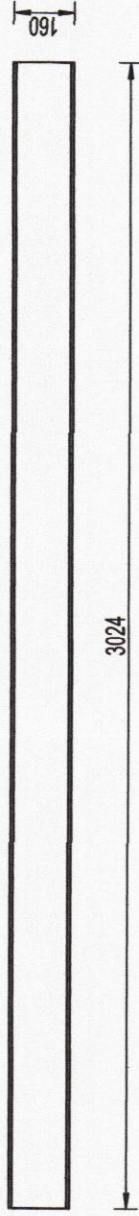

Detaliu 1

scara 1:10

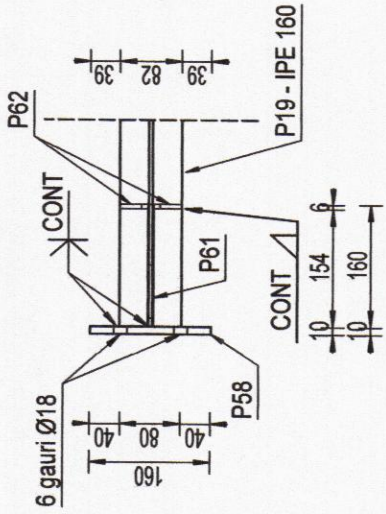

Sectiunea 1 - 1

scara 1:10

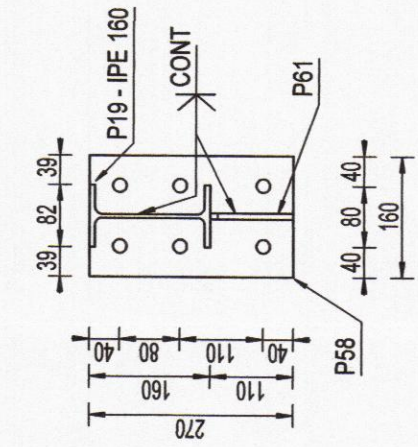

P58 - 2 buc.

tg. 10x160-270

scara 1:10

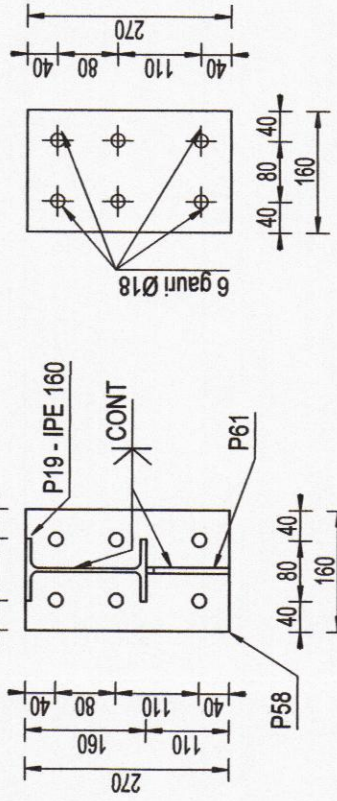

P62 - 8 buc.

tg. 6x39-145

scara 1:10

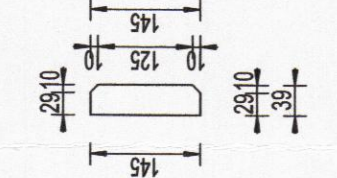

Detaliu 2

scara 1:10

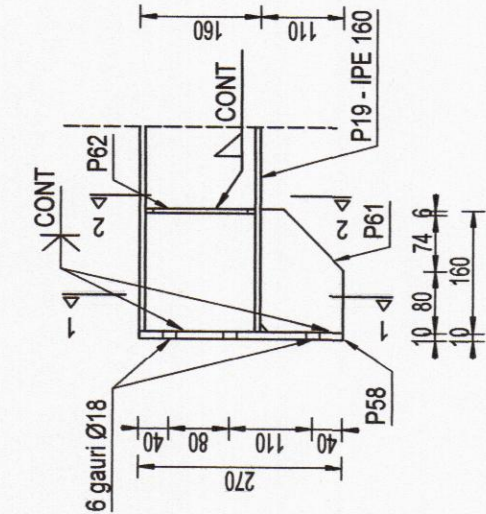

Sectiunea 2 - 2

scara 1:10

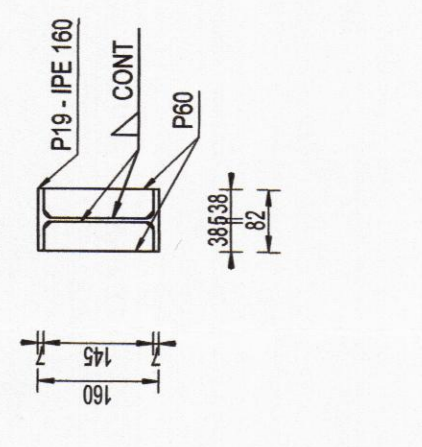

P61 - 2 buc.

tg. 8x110-160

scara 1:10

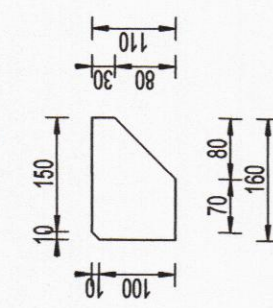

scara 1:10

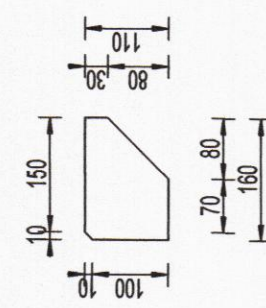

scara 1:10

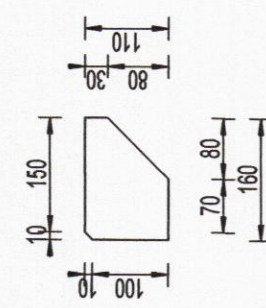

EXTRAS DE LAMINATE									
Pozitie	Denumire	Grosime	Latime	Lungime	Nr. Buc	Nr. Elem	kg/m	masa (Kg) kg/buc	Material
P19	IPE-160			3024	1	21	15.80	47.8	1003.4 S355-J2
P58	tg. 10x160-270	10	160	270	2	21	12.56	3.4	142.4 S355-J2
P61	tg. 8x110-160	8	110	160	2	21	6.91	1.1	46.4 S355-J2
P62	tg. 6x39-145	6	39	145	8	21	1.84	0.3	44.7 S355-J2
TOTAL LAMINATE							1236.96		
electrozi+grund (5%)							61.85		
Total (kg)							1298.8		

PROTECTIA ANTICOROSIVA:

*Gradul si tipul de curatire conform GP 111-2004:

- 1) Felul mediului - urban
- 2) Indicativul mediului - T-I-FN
- 3) Grad de curatire minim - 4

*Agresivitatea mediului conform STAS 10128/86:

- 1) Felul mediului - urban
- 2) Clasa de agresivitate a mediului - 2 m

*Categorii de coroziune:

C3 (medie), zona urbana

*Protectie minima:

- 1) grund: 1 strat - min. 40µm/strat
- 2) vopsea: 2 straturi - min. 40µm/strat

MATERIALE - conf. SR EN 10025:2004:

- a. S355J2 - bare laminate si table - structura principala
 - limita de curgere minimă $f_y = 355 \text{ N/mm}^2$;
 - modulul de elasticitate $E = 210000 \text{ N/mm}^2$

- b. Toate suruburile de prindere a ansamblurilor vor fi grupa 8.8.

*Categorii de executie a elementelor conform STAS 767/0-88:

Categorii de executie - B

*Clasa de calitate otelului conform SREN 1993-1-10/2006:

Clasa de calitate - 2

*Calitatea imbinarilor sudate conform Normativ C 150-99:

Nivel de acceptare a imbinarilor sudate - B

NOTE:

01. A se citi aceasta plansa impreuna cu plansele de arhitectura si instalatii si a se corela cu acestea;
02. Cota ± 0.00 a constructiei este definita in planurile de arhitectura;
03. Cotele relative sunt date functie de cota ± 0.00 definita la punctul 2;
04. La realizarea lucrarilor se va tine cont de normele de protectie, igiena si sanatatea muncii aflate in vigoare;
05. Sudurile ce se vor executa pe santier vor fi de tip continuu pe conturul elementelor;
06. Grosimile cordoanelor de sudura vor fi $0.7 \times t_{min}$;
07. Grosimea unui cordon de sudura nu va fi mai mic de 3mm.
08. Suprafetele metalice se vor proteja impotriva coroziunii conform caietelor de sarcini.
09. Sudurile se vor executa pe toata lungimea de suprapunere a pieselor.
10. Diametrul gaurilor va fi mai mare cu 2mm decat diametrul surubului.

scara 1:10

1. Planurile de rezistenta se vor citi cu planurile de arhitectura si instalatii!
2. Toate planurile de fundatii se vor citi impreuna!

scara 1:10

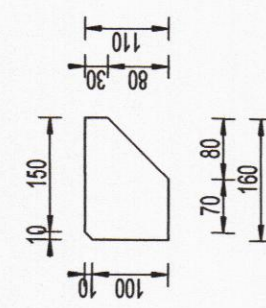

scara 1:10

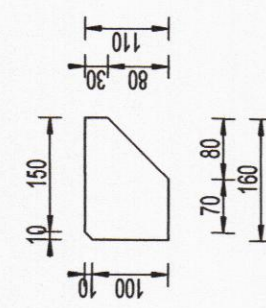

scara 1:10

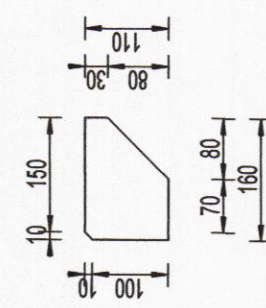

scara 1:10

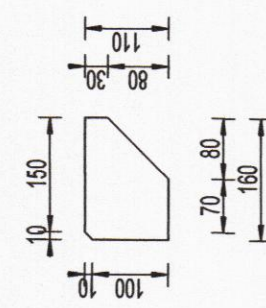

scara 1:10

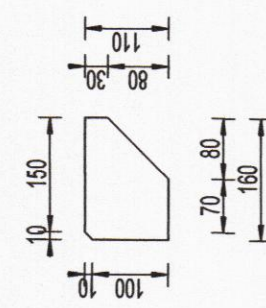

scara 1:10

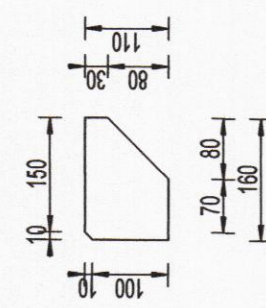

scara 1:10

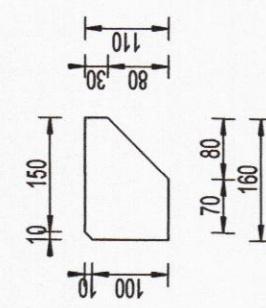

scara 1:10

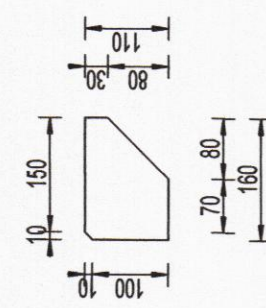

scara 1:10

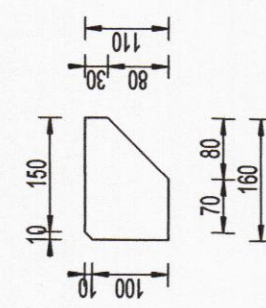

scara 1:10

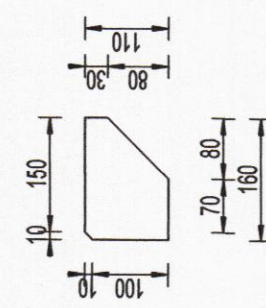

scara 1:10

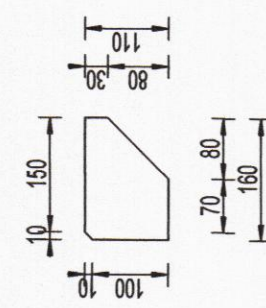

scara 1:10

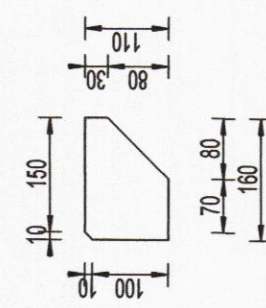

scara 1:10

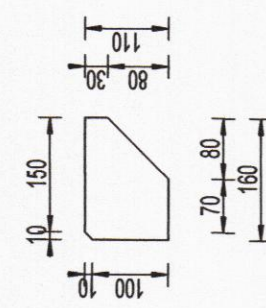

scara 1:10

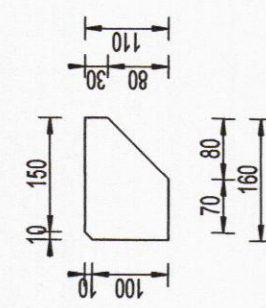

scara 1:10

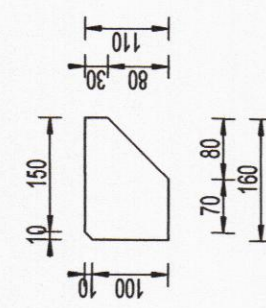

scara 1:10

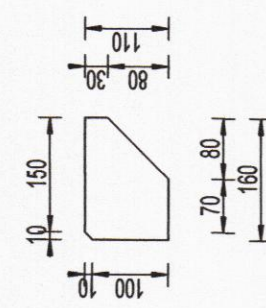

scara 1:10

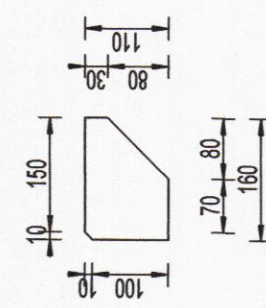

scara 1:10

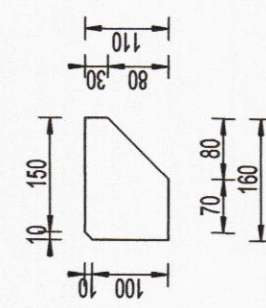

scara 1:10

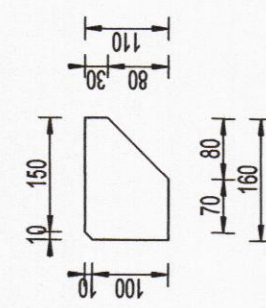

scara 1:10

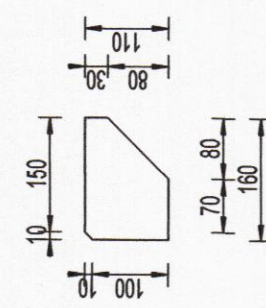

scara 1:10

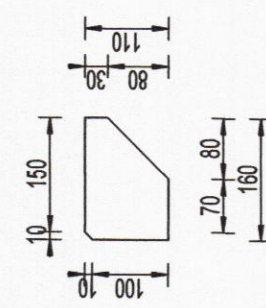

scara 1:10

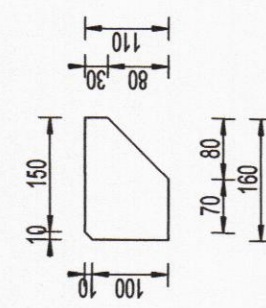

scara 1:10

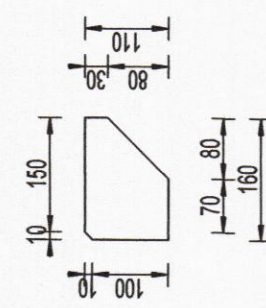

scara 1:10

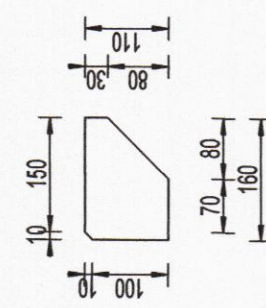

scara 1:10

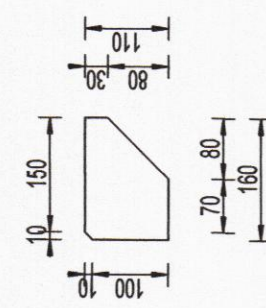

scara 1:10

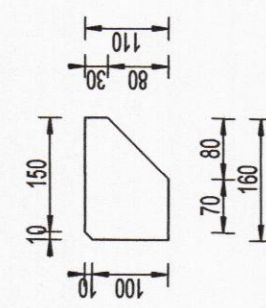

scara 1:10

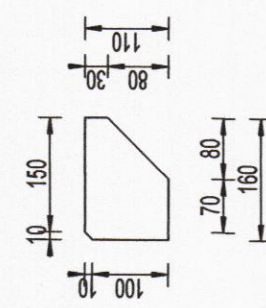

scara 1:10

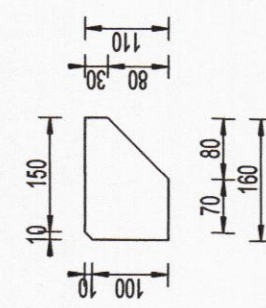

scara 1:10

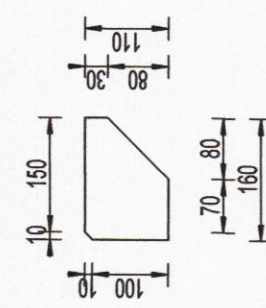

scara 1:10

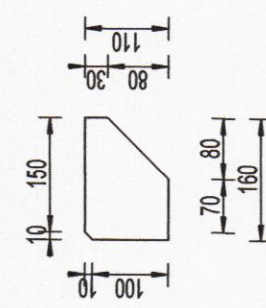

scara 1:10

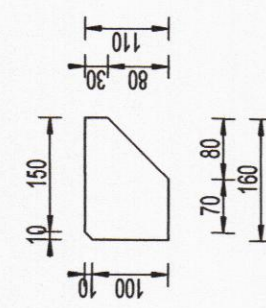

scara 1:10

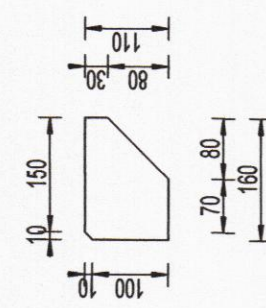

scara 1:10

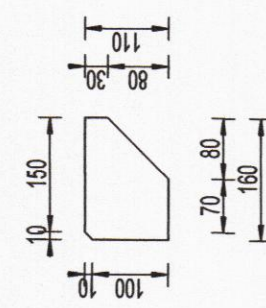

scara 1:10

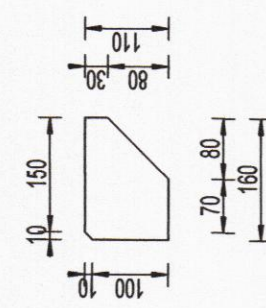

scara 1:10

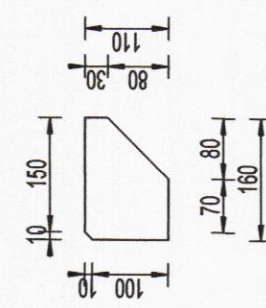

scara 1:10

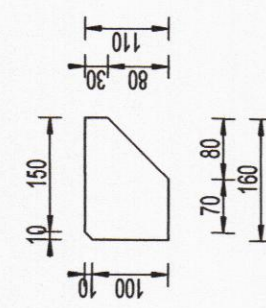

scara 1:10

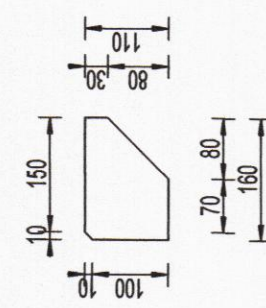

scara 1:10

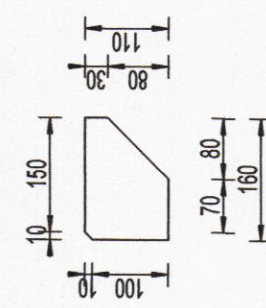

scara 1:10

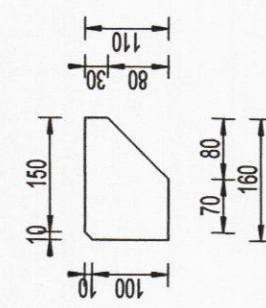

scara 1:10

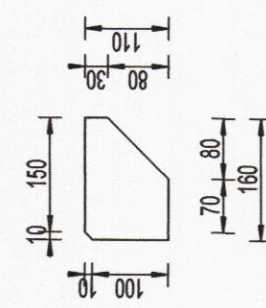

scara 1:10

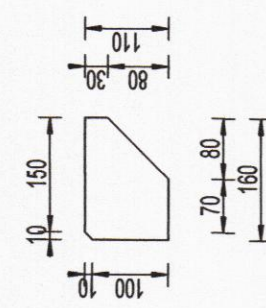

scara 1:10

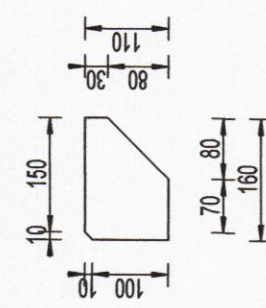

scara 1:10

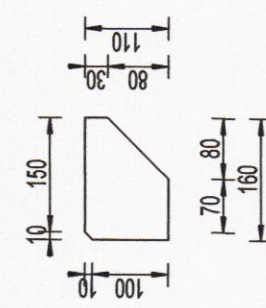

scara 1:10

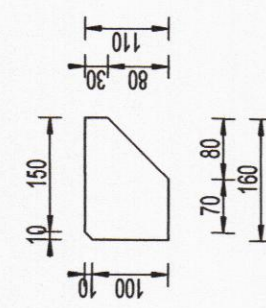

scara 1:10

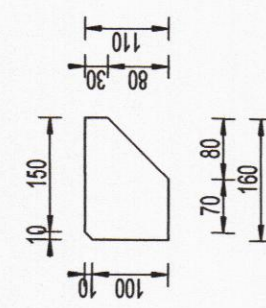

scara 1:10

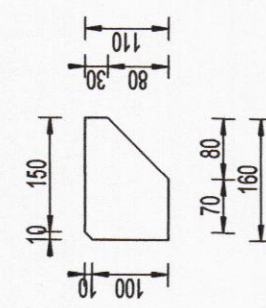

scara 1:10

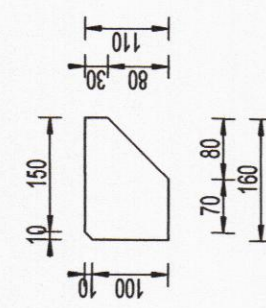

scara 1:10

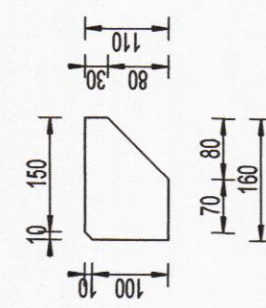

scara 1:10

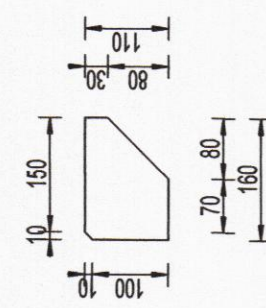

scara 1:10

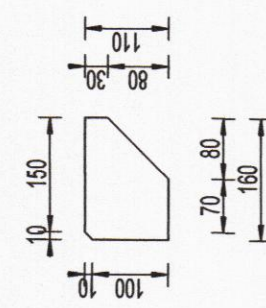

scara 1:10

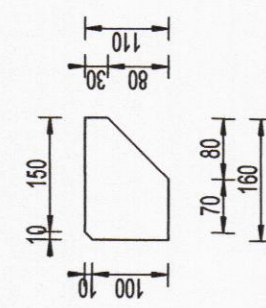

scara 1:10

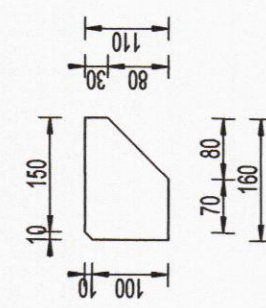

scara 1:10

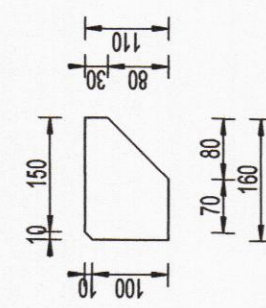

scara 1:10

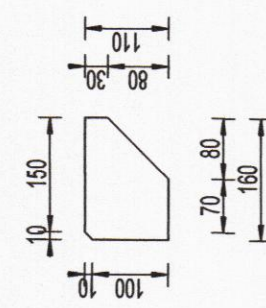

scara 1:10

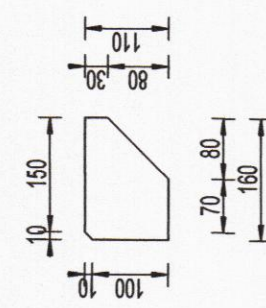

scara 1:10

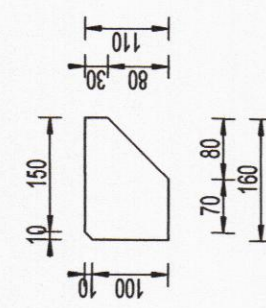

scara 1:10

